



BUSHTEC ORIGINALS



CAMP
SOLUTIONS



About Bushtec Originals

Bushtec Originals is the official brand for our canvas and PVC Fabric Range of products and offer solutions to the military, mining, commercial industry and disaster management.

Our tentage and containerised products are manufactured at our factories in Ladysmith by Canvas and Tent Manufacturing and Steelworx. We are a proudly South African brand and offer global solutions.

Canvas and Tent Manufacturing was established in 1968 and has a heritage that spans more than 50 years. We pride ourselves with the most modern factory which is ISO 9001:2015 and ISO 14001:2015 certified.

Bushtec Originals, a Bushtec Creations brand, is proudly covered by the Canvas and Tent Group.

About Redeployable Camp Systems SA (RCSSA)

Redeployable Camp Systems SA (Pty) Ltd is a proudly South African company specialising in the design and supply of redeployable turnkey camps for the medical, military and mining sectors. Our services include water purification, storage and reticulation, wastewater management and reticulation, power generation and reticulation, and intergration of PVC fabric structures and containerised solutions.

RCSSA continues to provide leading edge redeployable camp products and services to satisfy clients and offers specialised solutions like field hospitals, base camps to militaries around the world as well as exploration and workforce camps to the mining and oil-and-gas industries. We manufacture our own containerised solutions at our plant in Ladysmith.

RCSSA is ISO 9001:2015 certified, classified as level 5 System Integrator in terms of the Armscor systems hierarchy and an Electrical Contractors' Association (ECA) accredited contractor.

Our PVC range of products are manufactured at our Factory, Canvas and Tent Manufacturing (Pty) Ltd under the Bushtec Originals brand.

Partner with us to house your troops and workforce.





From Exploration to base camps our military graded canvas tents are durable

and well suited for the African environment and for disaster management...

Bow Tents



After a long hard day's work, relax your tired muscles in one of our range of bow tents. In densely humid locations, the two mosquito gauze windows allow cool air to flow into the tent while the heavy-duty zipper door keeps unwanted insects abay.

It's ideally suited for explorations, quick deployments and also suitable for disaster management. As an optional extra we can treat the canvas to be fire retardant.

Features:

- Water resistant canvas
- PVC built-in groundsheet
- Durable military specification ripstop canvas
- Sizes available: 3 x 3 x 2.1m / 2.4 x 2.4 x 2.1m / 2.1 x 2.5 x 2.1m / 2.1 x 1.85 x 2.1m

Rhino Camping Solution



Get to work quicker with Africa's first modular camping solution. The simple 'quick clip and zip' system allows you to set up your sleeping accommodation, dining area, office space and more in minutes. We provide the tent solution; you choose it's purpose.

Features:

- PVC floor system
- Roof ventilation ports
- Electrical inlet
- Lightweight ripstop canvas

Add-ons include the Rhino gazebo, Rhino anti-mozzie diner (half- and full-length), Rhino inner chalet style tent, side wall and apex panels.

Hip Tents



For short- or long-term use, choose our Hip Tent. Easily deployable, it can be used as sleeping accommodation, diner, kitchen, office and more. Not only is it made from military specification ripstop canvas, but it comes standard with detachable walls and free-standing roof.

Optional extras include a PVC groundsheet. The roof can also be supplied in PVC.

It is available in two sizes:

- 5 x 5m, sleeps between 4 and 8 people
- 5 x 10m, sleeps up to 12 people

Mess Hip Tents



Convenience is essential in remote areas. So, whether you need a diner, kitchen or office space, invest in the Mess Hip Tent: It is easily deployed and sets up rapidly. It comprises a free-standing roof of rip resistant canvas (ensuring a longer lifespan), shade-net roof and detachable walls with mosquito trim. As an optional extra you can add a PVC groundsheet.

It is available in two sizes:

- 5 x 5m, sleeps between 4 and 8 people
- 5 x 10m, sleeps up to 12 people

Features:

- Durable military specification ripstop canvas





From Exploration to base camps our military graded canvas tents are durable

and well suited for the African environment and for disaster management...

Canvas General Purpose Shelter

PVC General Purpose Shelter

T-Range

Inflatables



If you need accommodation, diner, kitchen, office, medical or area of entertainment, invest in this multi-purpose free-standing shelter.

Optional extras include interlocking tiles, electrical kits, air-conditioners and insulation.

As our entry level PVC structure shelter, we introduce the T-Range tents. If you need offices or accommodation facilities, the T-Range will be the perfect solution.

This multi-purpose free-standing frame tent, comes with roll-up windows and doors, all with sewn-in mosquito gauze netting and PVC bathtub floor. The T-Range is available in various sizes to accommodate between 10 to 50 people. The PVC material ensures that the tent can be air-conditioned and electrical kits fitted.

Features:

- Waterproof, Fire Retardant & UV Stabilised

Sizes available:

- T10 - 5x4m, 20m² (Sleeps up to 10 people)*
- T20 - 5x6m, 30m² (Sleeps up to 20 people)*
- T30 - 5x8m, 40m² (Sleeps up to 30 people)*
- T40 - 5x10m, 50m² (Sleeps up to 40 people)*
- T50 - 5x12m, 60m² (Sleeps up to 50 people)*

* Indicating the amount of people that can be fitted, if accommodated on bunk bed

Accidents do happen, so be prepared by investing in our inflatable shelter.

Easily assembled by one person in less than 10 minutes, it's the shelter of choice for quick on-scene response such as medical or disaster emergencies, including decontamination.

As an added benefit these tents can be interconnected.

Features:

- Lightweight 230V 50Hz inflation compressor
- Fire retardant material
- Sizes available: 5,15 / 7,55 / 9,95 x 5,6 x 2,8m

Canvas GP Shelter Specifications:

- Size available: 5.1 x 8,4m
- Colour: Standard Olive Drab
- Curtain style door (only one side)
- Windows: Clear PVC with mosquito nets
- Loose PVC floor optional

PVC GP Shelter Specifications:

- Sizes available: 6x6m, 6x8m, 6x10m
- Length can be extended to 6x12m
- Various colour options: Nato-white, Sand, White
- Single zipper door (optional on back of tent)
- Windows: Mosquito netting (optional on back of tent)
- Flysheet
- Complete with integrated PVC floor



From Exploration to base camps our military graded canvas tents are durable and

well suited for the African environment and for disaster management...

Warrior Shelters



Made to withstand extreme weather conditions, the sturdy and reliable Warrior Shelters and Centurion Shelters can be deployed as sleeping accommodation, dining, recreational and communication facilities, a kitchen, ablution units, gymnasium, hospital or office.

Optional extras include HVAC's, electrical and connector kits, solar shield, room dividers, hard doors, raised floors, PVC interlocking tiles and more.

Features:

- Waterproof, fire retardant and UV stabilised PVC
- Bathtub PVC groundsheet
- Soft floors and doors
- Windows with mosquito gauze and PVC flaps in layers

Warrior Specifications:

- Standard Warrior sizes: 4,8 x 4,8 x 2,8m (24m²) or 4,8 x 9,6 x 2,8m (48m²)
- Various colour options: White, Sand, Nato-white
- Length can be extended in increments of 2.4m's

Centurion Shelters



Centurion Specifications:

- Standard Centurion sizes: 6 x 8 x 3.1m (48m²)
- Various colour options: White, Sand, Nato-white
- Length can be extended in increments of 2m's

Gladiator Shelters



If you require a multi-purpose facility, invest in the Gladiator Shelter. Whatever your functional requirement, this large shelter can be configured as a dining, storage or recreational facility, as well as a gymnasium, workshop, warehouse or gathering hall. Optional extras include HVAC's, ceiling and extractor fans, electrical kits, solar shields, connector kits, PVC interlocking tiles, raised floors and hard doors.

Features:

- Waterproof, fire retardant and UV stabilised PVC
- Bathtub PVC groundsheet
- Soft floors and doors
- Windows with inner and outer mosquito gauze and PVC flaps
- Sizes available: 7,9 x 13,7 x 3,9m / 4,6m / 5,2m

Workshop Shelter



The Workshop Shelter is a rapidly redeployable shelter which can be mounted on ISO shipping containers by means of special beams with connections into the ISO locks.

This is ideal to be used for maintenance or storage of products. Containers can be utilized to store maintenance equipment when maintenance is done on vehicles.

Features:

- Width of covered area: 4.8m or 6m or 8m
- Length: 6m or 8m or 12m or 14m
- Shelter material: Heavy duty PVC
- Colours: olive green, white and desert sand
- Various floor protection options

BARREL TENT STRUCTURE

1. DOORS

From hospital swing doors to large roll-up aluminium garage doors, we have a large variety of door options to suite your specific needs. Doors can be added to the front and back end panels as well as the side of the Gladiator or Centurion shelter. Please feel free to enquire further about our vestibule portals and verandas.

2. POWER, LIGHTING AND HVAC

We offer additional power, lighting and air conditioning systems and fittings for infrastructure support.

5. SOLAR SHIELD

The solar shield is an important additional layer of the tent roof structure. Raised off of the PVC shelter body, the design optimises the temperature within the shelter and allows for better ventilation. The solar shield also adds to the durability of the shelter, protecting the PVC body from the harsh sun and weather. Our solar shield material is fire retardant and UV stabilised.

6. INNER LINER

The inner liner of the shelter insulates the shelter from the temperature outside. We offer a fully insulated liner, suitable for colder climates or half-capped, tropical liners suitable for the hot and humid climates. Various material thicknesses are available.

7. PVC BODY

We make use of the highest quality 550gsm PVC to ensure the durability of our shelters. In addition all our PVC undergoes a fire retardant, UV stabilised and anti-fungal treatment. Our PVC comes standard with full block-out to ensure no light passes through the material and that privacy requirements are met.

8. WINDOWS

Our windows are designed with four layers. The outer roll-up flap provides a barrier for wind and rain. A fixed netting is used to deter insects and allows for ventilation. The clear PVC layer allows for sunlight while preserving the internal HVAC temperature setting. Lastly our roll-down inner flap is used to block out light at night-time.

3. FRAME STRUCTURE

Our shelters can be developed in various configurations to suite your requirements. We offer three height options, a modular frame system to adjust the length of the shelter and connector kits for joining multiple shelters together. Our frames can be made of mild steel or aluminium and can be galvanised or powder coated according to your requirements.

4. FLOORING

Our shelters are designed with a standard heavy duty PVC bath tub floor, protecting the inside of the tent from water and dust. The shelter can be deployed either directly onto the ground, a concrete slab or a raised flooring structure complete with steps or ramps to suite your requirements. Additionally we offer PVC interlocking tiles to extend the lifespan of the PVC bathtub floor.

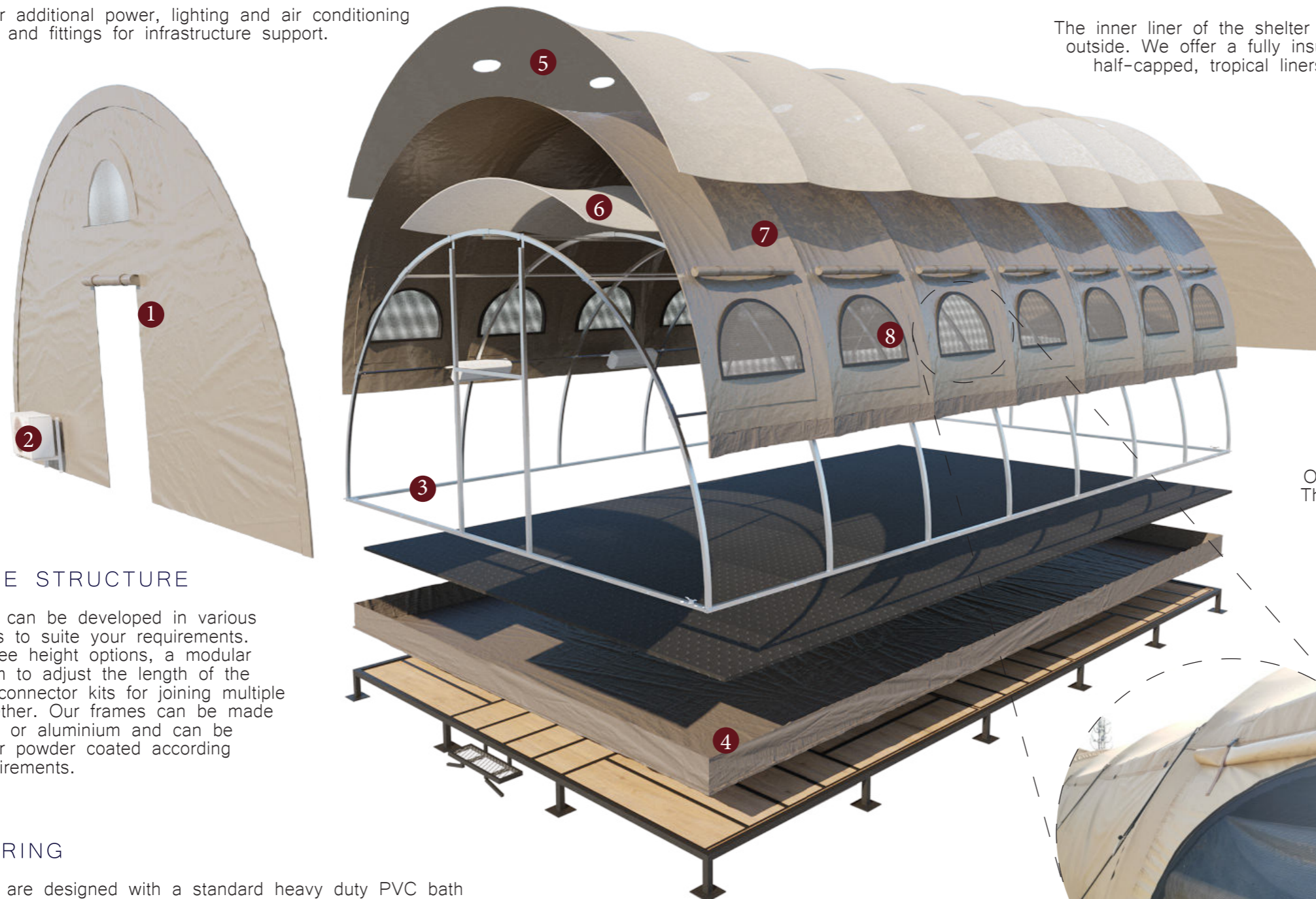

ROLL-UP PVC OUTER FLAP
(BUCKLE SET)

MOSQUITO NETTING

ROLL-DOWN CLEAR PVC
(VELCRO)

ROLL-DOWN INNER FLAP
(ZIPPER)

BARREL TENT STRUCTURE

FRAME STRUCTURE

Options available:



Powder coated mild steel structure

Galvanized mild steel structure

Aluminium structure

FLOORING

Options available:

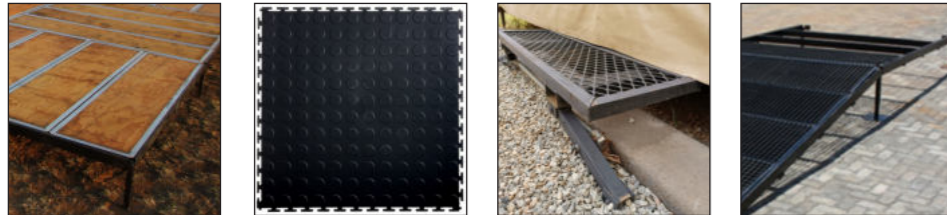

Raised flooring structure

Interlocking PVC tiles

Steps

Ramps

DOORS

Options available:



Standard roll-up zipper door (single/double)

Single hard door

Double hard door

Swing doors



Open end

Solid end

Barn door

Roll-up aluminium door (electrical)

Pull-up PVC door (manual)

Full curtain

INNER LINER

Options available:

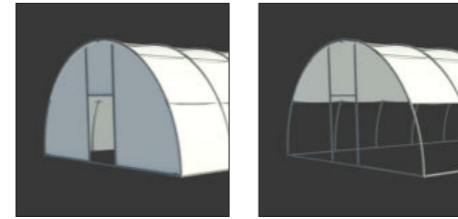

Full

Tropical half-cap

SIZE

Options available:

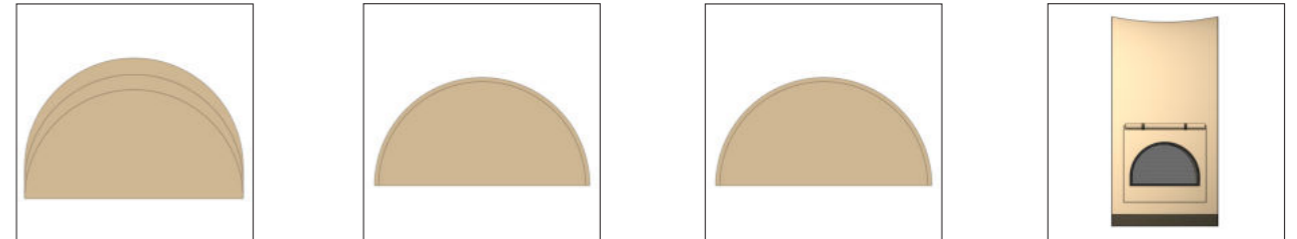

Gladiator
width - 7.9m
heights available - 3.9/ 4.5 / 5.1m

Centurion
width - 6m
height - 3.1m

Warrior
width - 4.8m
height - 2.8m

Modular length
Gladiator - 2m increments
Centurion - 2m increments
Warrior - 2.4m increments

ELECTRICAL

Options available:



SA

UK

EU (round/square)

Fluorescent lights

Led tube lights

Distribution board & fittings for single and/or 3 phase integration



Split unit HVAC

Militarized HVAC unit with ducting

PVC BODY

Options available:



White

Sand

Dark earth

Sand-white

Nato-white

Dark earth-white

SOLAR SHIELD

Options available:

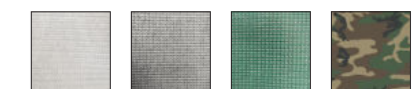

White

Beige

Green

Camouflage



From Exploration to base camps our military graded canvas tents are durable

and well suited for the African environment and for disaster management...

Field Shield

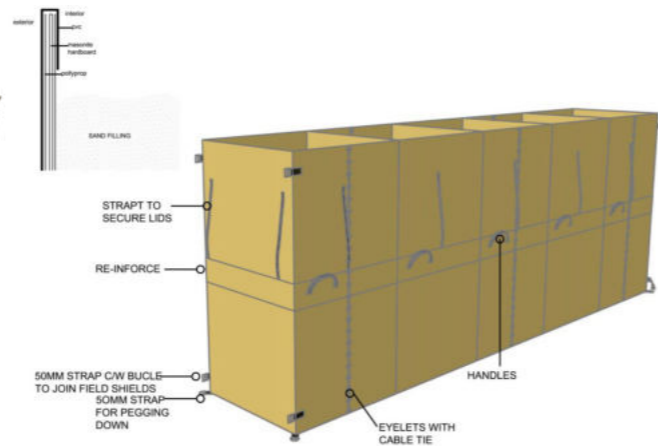

The Field Shield is designed to provide protection against small arms fire (5.56 - 14.5mm AP), cannon (20 - 40mm including HE, AP and long rod), grenades and RPGs. In practical tests the Field Shield proved capable of withstanding the blast of a 120mm Mortar Bomb, without breaching the wall. Correctly configured, a wall made from these units will mitigate the effect of a vehicle borne improvised explosive device, mortars (81 and 82mm), artillery (122, 152 and 155mm) and air delivered bombs (US MK 82).

Features:

- PVC material
- Consists of 3, 4 or 5 cells of 1.1 x 1.1m (w x l) each
- Dimensions: 3.3m(3 cells) or 4.4m(4 cells) or 5.5m(5 cells) x 1.5m or 2.1m (l x h)
- Stackable 3-high in pyramid formation
 - Fitted waterproof PVC cover
 - Double headed pegs
 - Ability to be filled with almost any material available on site

BushCad Modular Building System

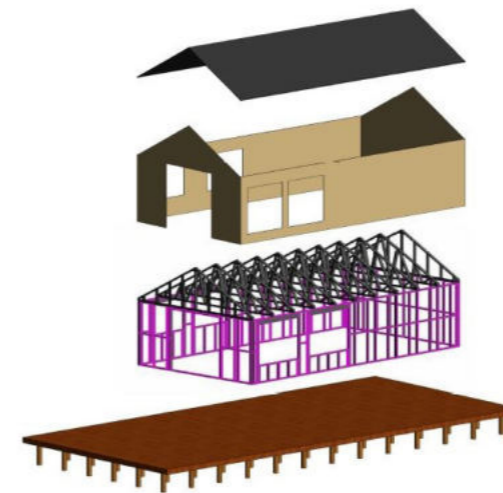

If you require a semi-permanent or permanent building solution, invest in the BushCad Modular Building System. It's durable, rapidly installed, easily redeployable and can be used as accommodation, classrooms, shops, offices, medical facilities or storage facilities.

Various options available, from open plan to 3 bedroom houses.

Features:

- Various finishing options available
- Internal electrical fittings and plumbing pre-installed
- Various floor layout options



HERCON SOLUTIONS

(Hard Walled Expandable Redeployable Container)



For the convenient temporary or semi-permanent accommodation solution, invest in the multi-purpose HERCon™ unit. Not only can it be cost-effectively transported, but it can also be rapidly deployed. The HERCon combines hinged hard wall technology within the frame of a 20ft (6m) container, 8ft (2.44m), 8.5ft (2.59m) or 9.5ft (2.9m) in height to create a fully assembled and self-contained unit, which expands to a floor area about 3 times its shipping footprint.

Each unit can be linked end-to-end to form larger buildings. Electrical wiring and plumbing are pre-installed to ensure it is operational within 50 minutes after deployment. Optional extras include air-conditioners, carpeting and furniture.

Features:

- CSC certified shipping container frame rated for 3-high stacking and inter-modal transportation. (The low cube [2.4m high] version allows for transportation by Hercules C130 aircraft)
- High cube/Low cube (1C) Format
- Road, Rail, Air and Sea transport

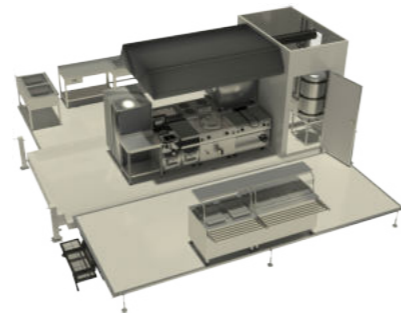

Whatever your functional purpose, potential configurations include:

- Open plan conference facility
- Dormitory-style accommodation
- Single, double or four person living unit with one to four bedrooms and en-suite ablution area (toilet, basin and shower) with or without a central passageway
- Kitchen / Kitchenette and lounge area
- Office unit with reception and boardroom
- Two to four offices with an en-suite ablution area
- Storage room
- Ablution unit
- Clinic / Specialised medical facility



HERCon Medical



HERCon Accommodation



HERCon Ablution



HERCon Kitchen



HERCon Offices and Command Centers

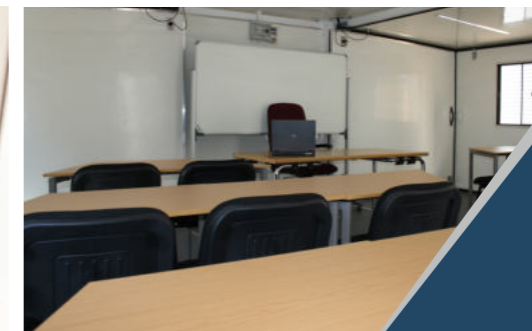
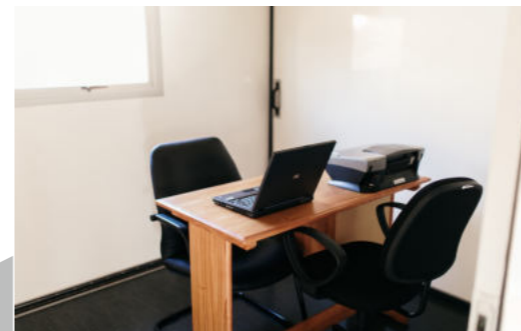

Canteen Unit



Bar Unit



Barber Unit



Whether a new or used shipping container, we have the ability to convert it into any facility you would require, from a fast moving military force or workforce.

From a basic guard house to a complex item such as a kitchen, canteen or even barber shop, we are capable of designing, manufacturing and installing it to your requirements and needs.

As in the case of the HERCon™, these units can be supplied with our unique quarter height container to support members in the field with fresh water and collecting all grey and black water. Hereby supporting the complete and independent deployment of these units.

The quarter height container is supplied to assist the client during the initial deployment of an installation crew, allowing for an autonomous deployment in support of 10 members for a period of 36 hours.

The system has separate 1350lt portable and sewage holding tanks and can be either refilled and cleaned or directly coupled to the required services once available on site.

It can be incorporated with any of our water based products, whether an ablution facility, barber shop or canteen and can also be used independently in support of water and sewage reticulation.

Canopy and Vestibule



SITE SOLUTIONS

MANAGER ACCOMMODATION



Floor Plan - Manager Accommodation

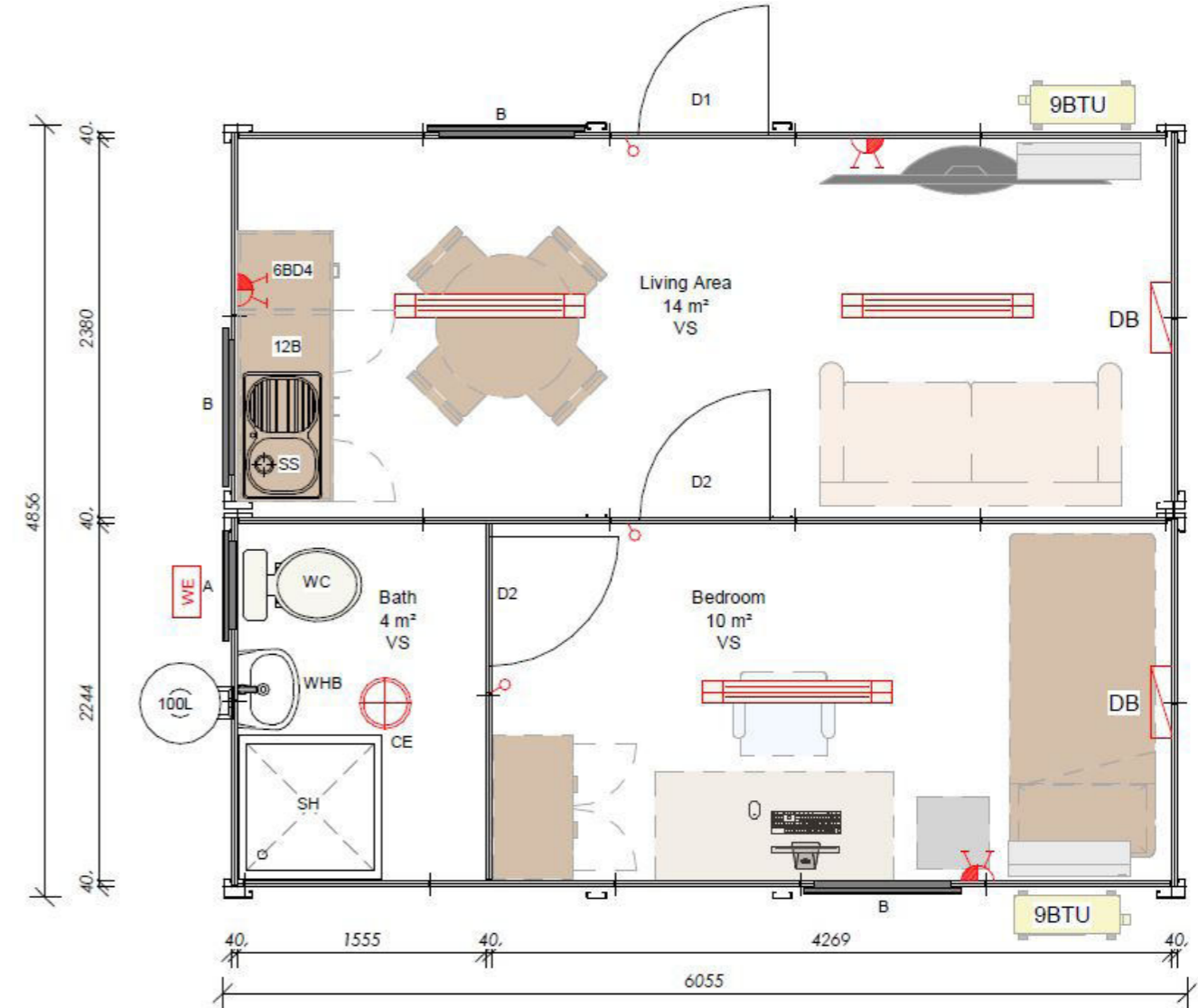

Modular/PreFab Units

Private air-conditioned single unit with en-suite bathrooms housed in a 5,8 x 4,6m unit with own porch consisting of the following:

- Double bed with mattress and linen
- Bedside pedestal with bedside lamp
- Desk, chair and desk lamp
- Lounge chair
- Wardrobe
- Bar fridge
- TV
- Curtains or blinds
- Outside table and 2 chairs



SITE SOLUTIONS

MANAGER / ARTISAN ACCOMMODATION



Ablutions & Change Houses of various configurations

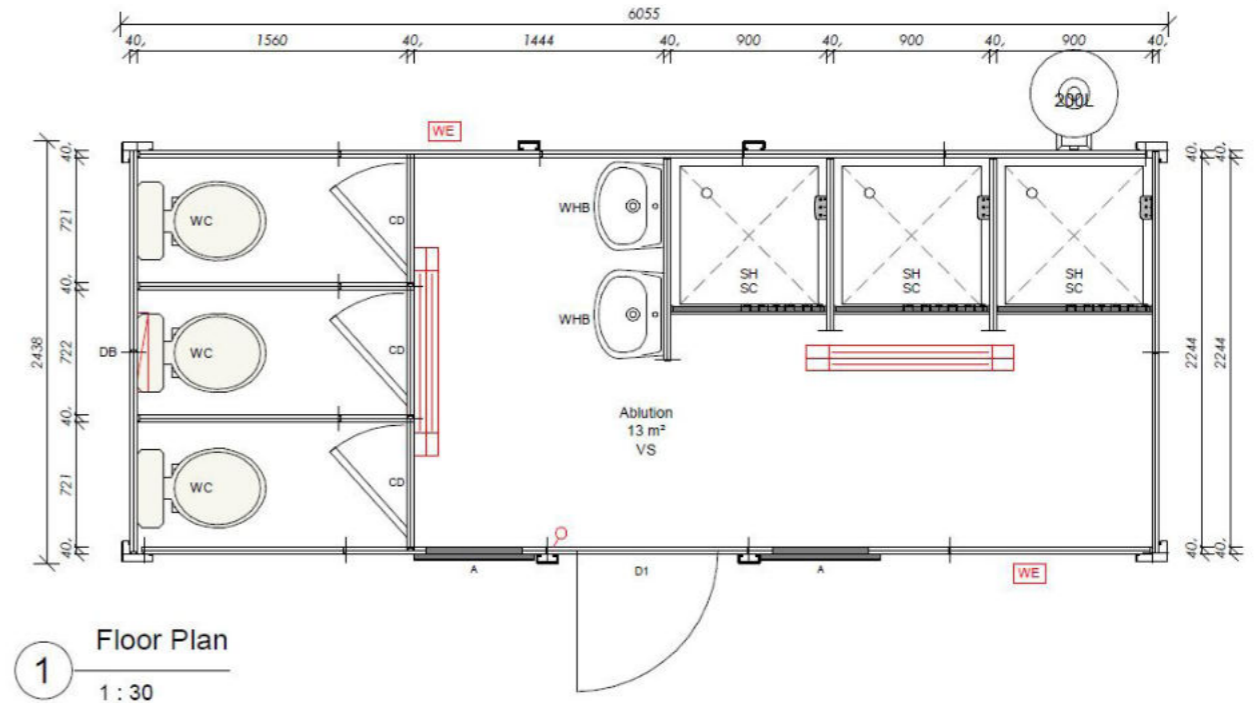

Containerised Solutions - Transpaq

Private air-conditioned single unit with en-suite bathrooms housed in a 5,8 x 4,6m unit consisting of the following:

- Single bed with mattress and linen
- Bedside pedestal with bedside lamp
- Desk, chair and desk lamp
- Lounge chair
- Wardrobe
- Bar fridge & TV
- Curtains or blinds
- Outside table and 2 chairs





Design

We design and integrate camp systems to meet your requirements, be it a basic 10 person fly camp or a 2000 person construction camp.



Installation & Commissioning

Our experienced installation teams can set up and commission the camp anywhere in the world from the desert to the Antarctic.



Maintenance

Although most of our customers operate and maintain their own systems and camps, RCSSA provides a maintenance service on request.



Power Generation & Distribution

We offer complete power generation and distribution solutions, no matter how remote the location. This is designed to your requirements, from 20 KVA to multiple auto-synchronized gensets of 400 KVA and more. Our products are Plug-and-Play systems, which do not require an electrician to be on site.



Redeployment

Many of our facilities can remain in the same location for 10 years or more, or can rapidly be relocated without leaving a footprint that is harmful to the environment. We can also assist in relocating the complete camp system if so required.



Sewage Treatment & Waste Management

Our various redeployable biological sewage treatment plants are designed to the required capacity and produce effluent that can safely be returned to the environment.



Water Purification, Storage & Reticulation

Our water purification systems (whether trailer-mounted, containerised or skid mounted) can include filtration, chlorination, sterilisation, reverse osmosis and desalination. We can also include sedimentation, if this is a requirement, to produce portable water which meets South African and world standards. Mesh dams, bladders and tanks are used for water storage and flexibility is assured by the use of quick couplings in the plug-and-play reticulation design.



Training

On-site training prior to deployment is recommended and indeed specified by clients in many of our contracts. This ensures that personnel setting up and operating the systems are able to do so efficiently and competent to carry out routine maintenance. We provide training and user manuals that assist in prolonging the lifespan of the structures and systems.



Transport & Logistics

RCSSA makes use of experienced and specialised service providers when arranging transport and logistics support. Clients are welcome to use their own means of transportation.



Accessories

We provide anything from bedding to complex medical equipment to meet our client's requirements.

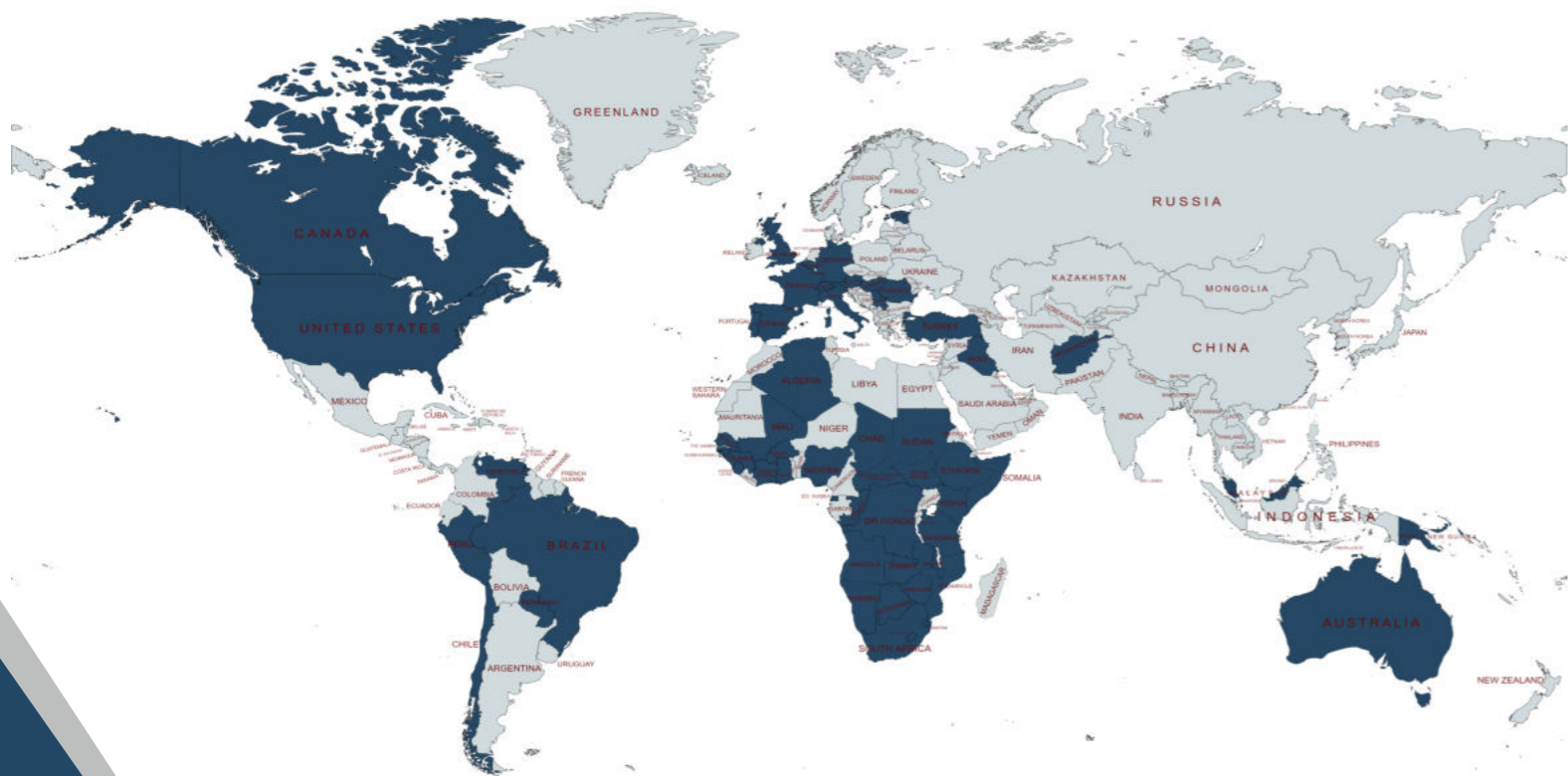

- Afghanistan
- Algeria
- Angola
- Australia
- Austria
- Belgium
- Botswana
- Brazil
- Burkino Faso
- Canada
- Central African Republic
- Chad
- Chile
- Congo
- Côte d'Ivoire
- DR Congo
- Ethiopia
- Estonia
- Eswatini
- France
- Germany
- Ghana
- Guinea
- Guinea Bissau
- Hungary
- Italy
- Iraq
- Kenya
- Lesotho
- Malaysia
- Malawi
- Mali
- Mozambique
- Namibia
- Nigeria
- Paraguay
- Papua New Guinea
- Peru
- Portugal
- Romania
- Senegal
- Serbia
- Sierra Leone
- Spain
- Somalia
- South Africa
- South Sudan
- Sudan
- Switzerland
- Tanzania
- Turkey
- United Kingdom
- United States
- Venezuela
- Zambia
- Zimbabwe

To best guide our clients and assist in making an informed decision when choosing a redeployable turnkey camp solution provider, Canvas and Tent and RCSSA offers the following checklist:

CHECKLIST ITEMS	RCS
ISO 9001:2015	✓
Own Fully SABS certified factory	✓
BEE certification	✓
Design	✓
Installation	✓
Training	✓
Maintenance	✓
Transportation	✓
Redeployment	✓
Turnkey Solutions	✓
Global reach	✓
Infrastructure support systems	✓
Power generation and distribution generator	✓
Water purification, storage and reticulation	✓
Sewage treatment and waste management	✓
Connector kits for joining shelters	✓
Pioneer camp solutions / Workforce camps	✓
Fly camps/ Exploration camps	✓
Solutions for all harsh climate conditions	✓
Military solutions eg. base camp accommodation	✓
Forward base	✓
Medical facilities	✓
Wards	✓
Field Hospitals	✓
Containerised solutions	✓

FULL TURNKEY CAMP SOLUTION



LEGEND:

- 1. Solar Shield Covering Shelter
- 2. Expandable Containers
- 3. Field Kitchen
- 4. Large Modular Structure

- 5. Sewage Treatment & Waste Management System
- 6. Water Purification, Storage & Reticulation
- 7. Power Generation & Distribution

- 8. Field Shield
- 9. Gladiator Shelter
- 10. Workshop Shelter
- 11. Cold Storage
- 12. HERCon

- 13. Guard house
- 14. Warrior Shelter
- 15. Perimeter Protection

- Water
- Waste
- Electrical

PREVIOUS PROJECTS

Medical Projects



Military Projects



Mining Projects





CONTACT US



+27 (0)12 671 1010



info@rcssa.com



www.rcssa.com



Redeployable Camp Sytems,

Denel Business Park,

Nellmapius Drive, Irene,

Centurion